

WASHBURN COUNTY FOREST
INTEGRATED MANAGEMENT / PROSPECTUS WORKSHEET
SALE #

Tract # 33-23

DESCRIPTION: SW Sec. 9 T42N-R10W (FROG CREEK E)

VOLUME, SPECIES & PRICE:

2100 Tons Mixed Hdwd. (~ 870 cds. 40% hard maple, 30% ash, 25% red maple, 3% white and yellow birch and 2% red oak) 2.4 ton/cd

370 Tons Basswood (~190 cds.) 1.9 ton/cd

60 Tons Aspen (~25 cds.) 2.2 ton/cd

64 MBF Basswood

37 MBF Red Maple

25 MBF Ash (80% white ash and 20% black ash)

10 MBF Mixed Hdwd. (80% hard maple, 15% white and yellow birch and 5% red oak)

TOTAL MINIMUM BID \$26,406.00

Note: 3 year contract

CUTTING INSTRUCTIONS:

AREA A[N. Hdwd]: Harvest all orange marked trees between purple marked gaps within designated boundaries. Within purple marked gaps (~120 ft. across) harvest all merchantable trees except "ringed" marked reserve trees. Site maintenance required within the gaps: sever all un-merchantable stems >1". (70 acres)

Access, roads & landings:

- No new roads will be permitted. Reconstruction of existing forest trails will be needed.
- Landings shall be located where indicated on the prospectus map unless prior approval is obtained from the County Forest Administrator.

BMP's:

- No slash will be left in any non-forested wetlands. Do not operate wheeled or tracked equipment within 15 feet of wetlands except during frozen conditions.

Slash:

- Contractor is encouraged to leave large tops within purple marked gaps to help discourage deer browsing hardwood seedlings.

Seasonal Restrictions:

- Harvest operations restricted to frozen ground conditions.

All additional restrictions listed on the prospectus sheet apply unless otherwise specified.

MANAGEMENT CONSIDERATIONS

AREA A: is a northern hardwood stand scheduled for a group selection harvest with canopy gaps and single tree selection in-between. Level to rolling topography on silt loam soils with frozen harvesting conditions required.

ACRES 70

Washburn County Forest
Timber Sale Prospectus Map - Tract 33-23
Sec. 9 T42N-R10W (FROG CREEK E)

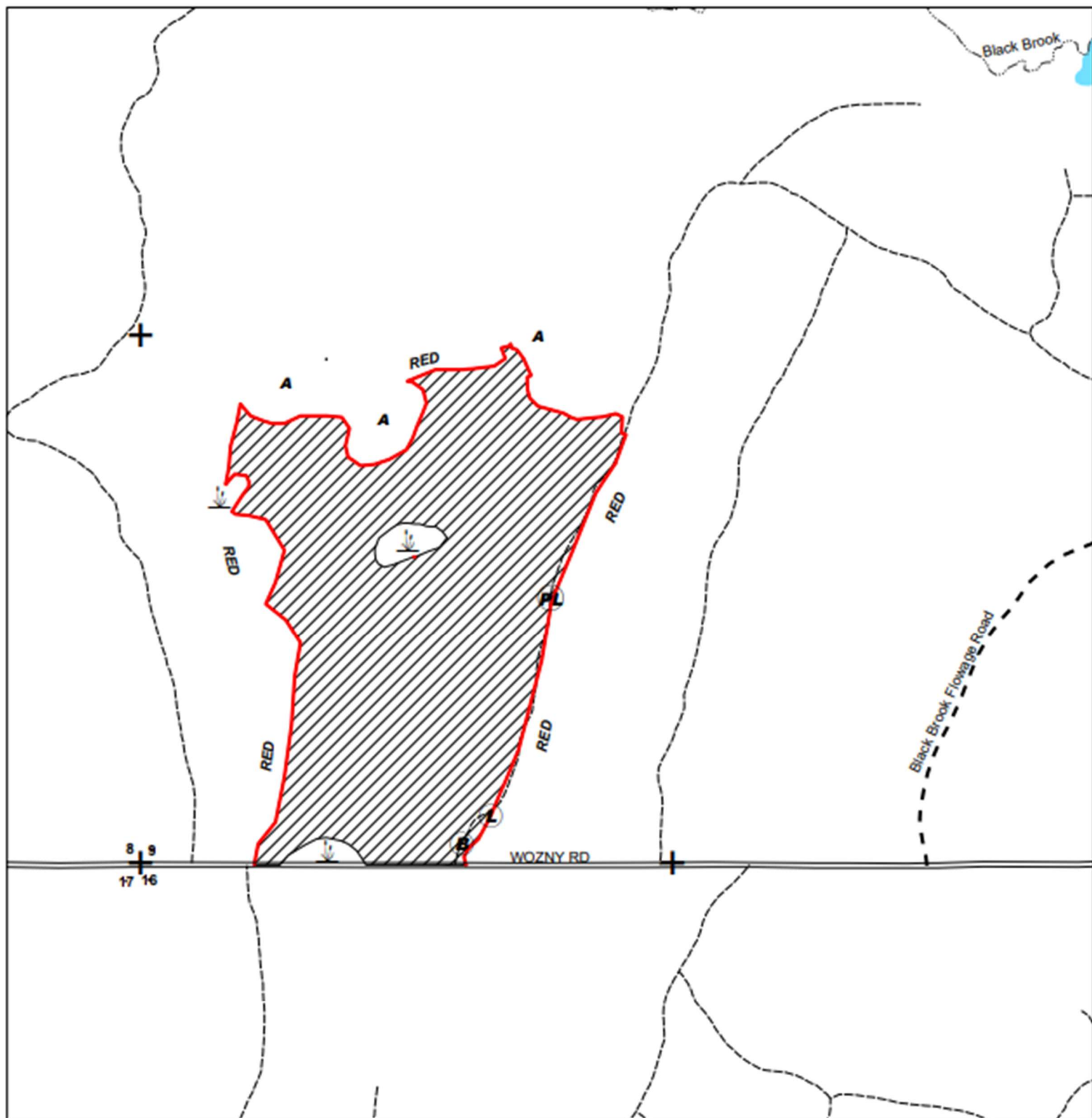

Legend

Berm	Proposed Landing	Area A: N. Hdwd Gap and Thin	Boundary — RED
Landing	Wetland	Aspen	

