

WASHBURN COUNTY FOREST
TIMBER SALE PROSPECTUS

Tract # 16-20 Comp. # 74

DESCRIPTION: SW 1/4, Section 19, T.41N.- R.-13W. (Chicog)

VOLUME, SPECIES & PRICE:

785 Tons Red Pine (Approx. 375 cd.) Includes small amount of Jack Pine

TOTAL MINIMUM BID: \$ 3,768.00

Note: 3 year contract

CUTTING INSTRUCTIONS:

- **Area A:** [Red Pine]: 1st Thinning. Unmarked Row Thinning. Harvest every third row, leaving 2 rows intact on the outside edges of the plantation. Skip low stocked red pine areas that will result in corridors wider than 20 feet. Also harvest all jack pine in the Sale Area. Orange marked trees along the recreation trail are to be harvested to improve access. (35 acres)

Seasonal Restrictions:

- All pine cut or piled between May 1st and August 1st shall be removed within 30 days.

Skidding:

- No Pole skidding allowed April 1st through July 15th without permission.

Access:

- There are 3 red dots on trees where the edge of the plantations intersects the recreation trail
- North access road has been opened up and improved. Proposed landing will still need to be put in.
- Recreation trail is always to remain free of debris and snow covered during the winter. Contractor is required to restore the recreation trail to at least its existing condition. Any signs or posts damaged or destroyed will be replaced by the contractor.

Private Property

- The West side of the sale is adjacent to Burnett County. Logging operations on Burnett County land are limited to the proposed skid trail as outlined on the map.

Survey Monument

- Avoid government survey monument illustrated on prospectus map.

Landings:

- Decking of wood allowed along the Washburn County Fire Lane/recreation trail as long as the decked wood does not extend out onto the road surface.
- Decking of wood along the township road will require written permission from the township.

All additional restrictions listed on the prospectus sheet apply unless otherwise specified.

MANAGEMENT CONSIDERATIONS

Area A: 1st Thin Red Pine Plantations: The objective for these 2 Red Pine Plantations is to maximize tree vigor and stand growth to facilitate optimized productivity (quantity and quality) of a variety of timber products (e.g. sawtimber, pulpwood, utility poles, and cabin logs). This first thinning will focus on geometric spacing and providing access for future thinnings. Topography is rolling and Soils are sand. All season logging chance.

ACRES: 35

WASHBURN COUNTY FOREST TIMBER SALE PROSPECTUS - TRACT 16-20 SEC 19 T41N R13W

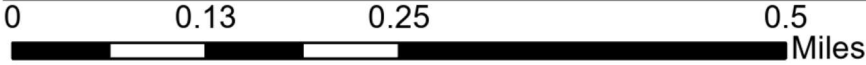
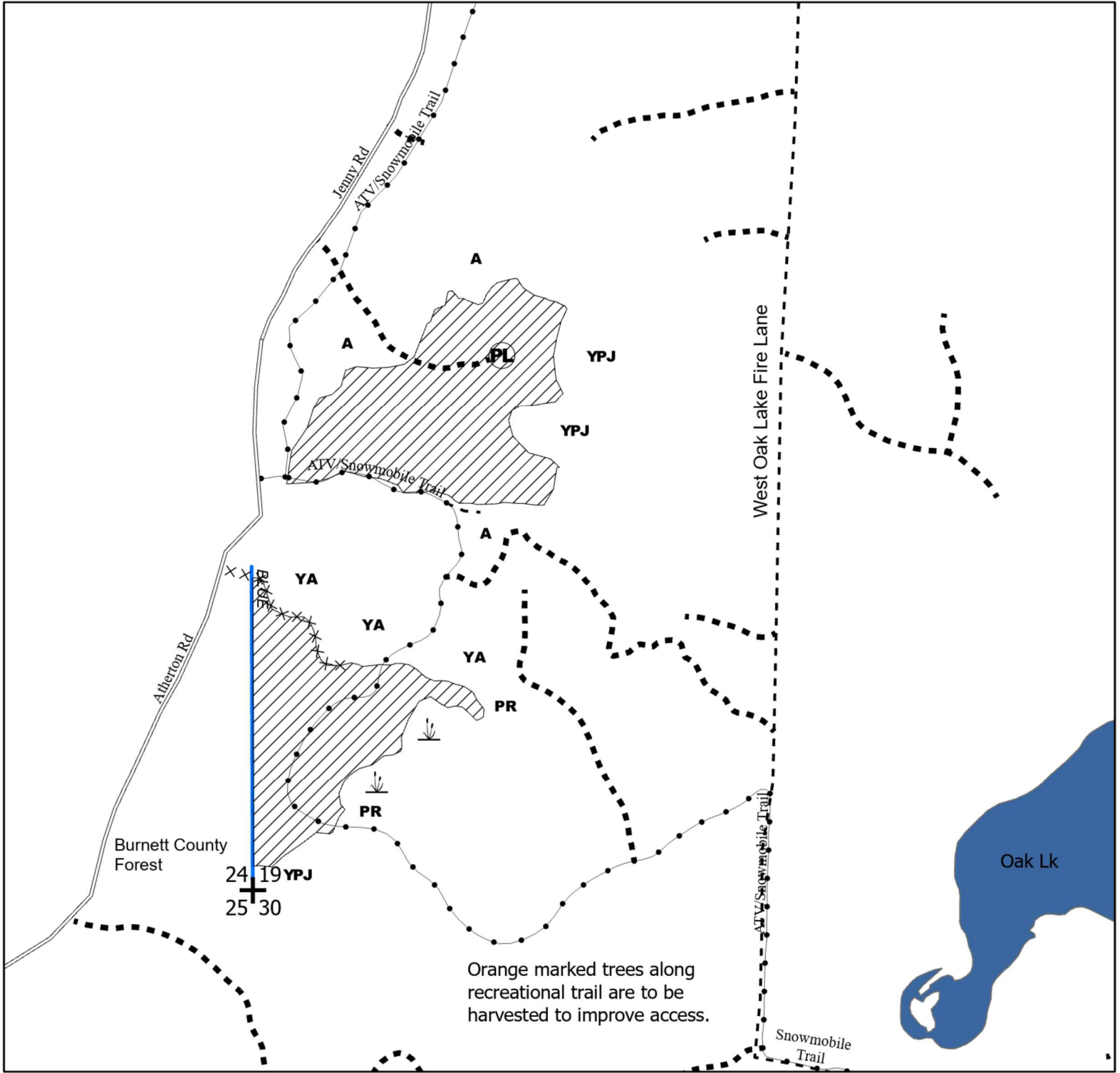

- | | | |
|------------------|-----------------------|----------------------|
| AREA A: RED PINE | A ASPEN | xxx SKID CORRIDOR |
| PROPOSED LANDING | YA YOUNG ASPEN | BLUE |
| CORNER | YPJ YOUNG PJ | TOWNSHIP ROAD |
| WETLAND | PR PR | ATV/SNOWMOBILE TRAIL |

