

WASHBURN COUNTY FOREST
INTEGRATED MANAGEMENT / PROSPECTUS WORKSHEET
SALE #

Tract # 2-21 Comp. # 112 Photo: Yr. WisFIRS copy Flt. #

DESCRIPTION: E1/2NE, NESE Sec. 25, T40N-R12W (TREGO)

VOLUME, SPECIES & PRICE:

1900 Tons Red Pine (~845 cds.)

170 Tons Aspen (~75 cds.)

100 Tons Jack Pine (~45 cds.)

3 Year Contract
TOTAL MINIMUM BID \$14,358.00

CUTTING INSTRUCTIONS:

AREA A [red pine]: First thinning. Harvest every third row, leaving 2 rows intact on the outside edges of the plantation. Individual rows are not marked. Also harvest all jack pine and aspen within the plantations boundaries. [94 acres].

Access & roads:

- ▶ No new roads will be permitted. Reconstruction of existing forest trails will be needed.
- ▶ Recreation trail surface will have to be restored to at least existing condition and any damaged signs/posts will have to be replaced by the contractor.
- ▶ Recreation trail shall be maintained snow covered during winter months and free of debris at all times.

Landings:

- ▶ Decking of wood allowed along the recreation trail as long as the decked wood does not extend out onto the trail surface.
- ▶ Decking of wood along the township roads will require written permission from the township.

Skidding restrictions:

- ▶ No pole skidding allowed April 1st through July 15th without permission.

Seasonal restrictions:

- ▶ Pine cut or piled between May 1st and August 1st shall be removed within 30 days to prevent bark beetle infestation.

Private land:

- ▶ No slash or logging debris will be left across the blue line onto private land.

All additional restrictions listed on the prospectus sheet apply unless otherwise specified.

MANAGEMENT CONSIDERATIONS

Area A: is a 30 year old red pine plantation scheduled for a row sequence first thinning. Level topography on sandy soils with an all season logging chance.

ACRES

94

Washburn County Forest
 Timber Sale Prospectus Map - Tract 2-21

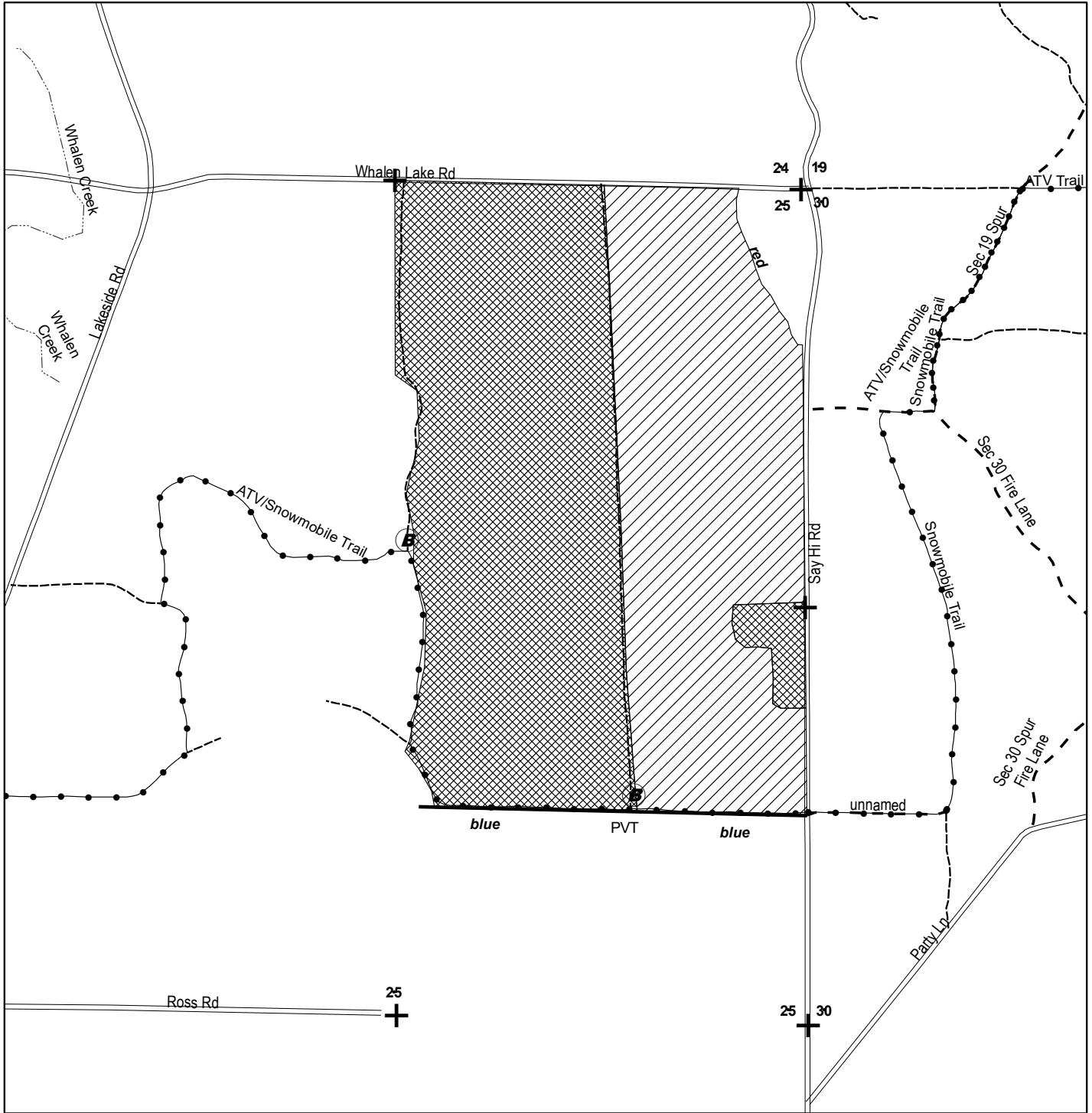

Legend



Berm — private line



Area A: red pine

PVT

pvt



Area J: Adjacent Sale

