

WASHBURN COUNTY FOREST
INTEGRATED MANAGEMENT / PROSPECTUS WORKSHEET

Tract # 1-23

DESCRIPTION: SW Sec. 21, N1/2NW Sec. 28, T40N-R13W (Casey)

VOLUME, SPECIES & PRICE:

1100 Tons Red Pine (~ 490 Cds., includes ~53 MBF)

10 Tons Mixed Hardwood (~5 Cds., 50% White Birch, 25% Aspen, 25% Red Maple) 2.32 tons/cord

TOTAL MINIMUM BID: \$14,444.00

Note: 3 year contract

CUTTING INSTRUCTIONS:

AREA A [Red Pine]: Harvest all orange marked trees within the designated boundaries. [49 acres]

Access, roads and landings:

- ▶ No new roads will be permitted. Reconstruction of existing forest trails will be needed.
- ▶ Landings shall be located where indicated on the prospectus map unless prior approval is obtained from the County Forest Administrator.
- ▶ Decking of wood allowed along the WCF fire lanes as long as the decked wood does not extend out onto the road surface.
- ▶ Recreation trail shall be maintained snow covered during winter months and free of debris at all times.
- ▶ Recreation trail surface will have to be restored to at least existing condition and any damaged signs/posts will have to be replaced by the contractor.
- ▶ Gates to sale area shall be closed during non-working hours.

Seasonal Restrictions:

- ▶ Pine cut or piled between May 1st and August 1st shall be removed within 30 days.

Skidding:

- ▶ No pole skidding allowed April 1st through July 31st without permission.

All additional restrictions listed on the prospectus sheet apply unless otherwise specified.

MANAGEMENT CONSIDERATIONS

Area A: Is a 37 year old Red Pine plantation scheduled for an improvement second thinning. Level topography on sandy soils with an all season logging chance.

ACRES

49

Washburn County Forest
Timber Sale Prospectus Map - Tract 1-23
Sec. 28, T40N-R13W (CASEY)

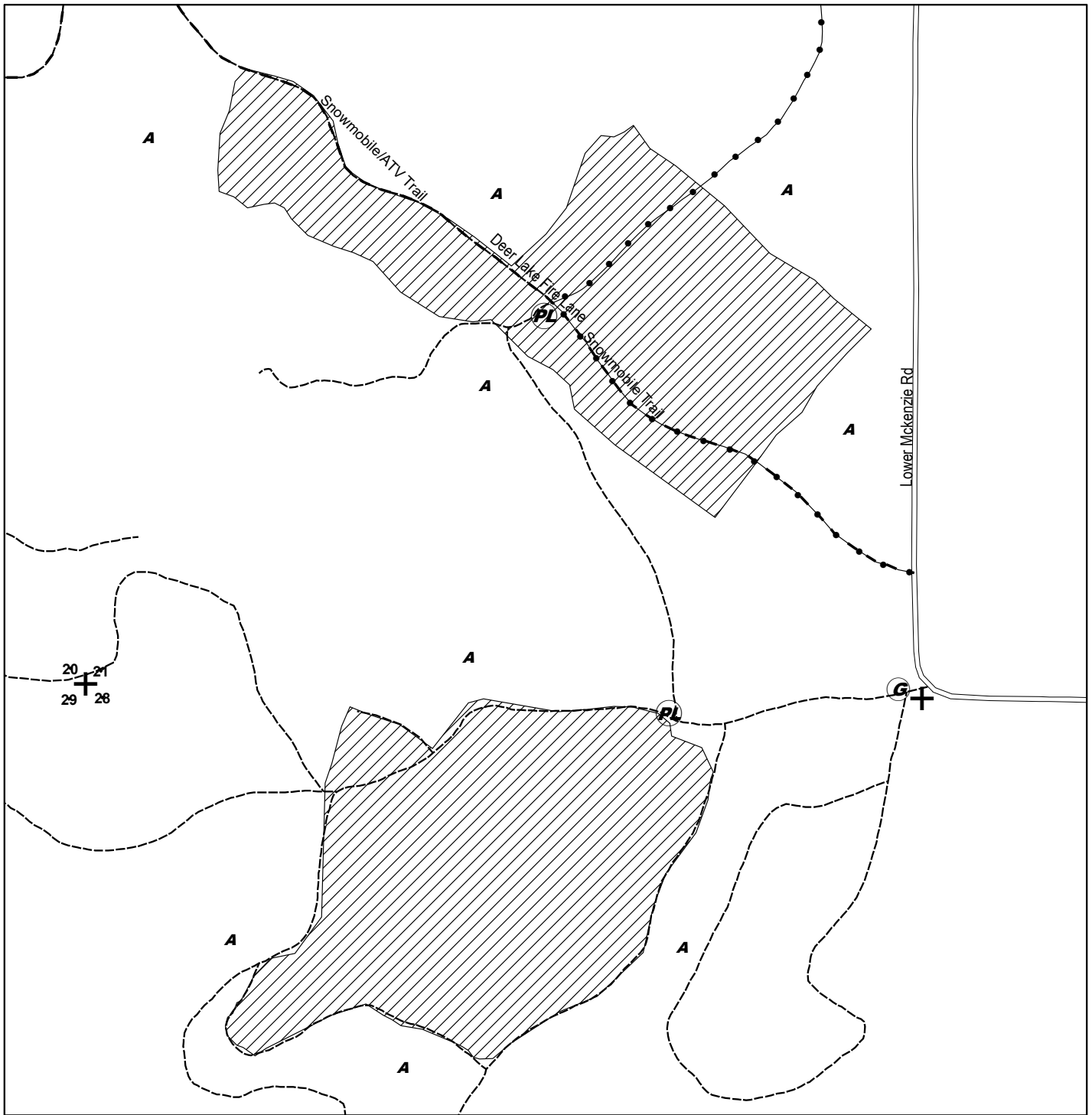

Legend

 Gate

 Aspen  Area A: Red Pine

 Proposed Landing

